

Long Barrel - Four Hole Tongue with Closed Transition

Type BBLU-FN

- Manufactured from high conductivity seamless copper tubing
- Tin-plated to inhibit corrosion
- Beveled entry for easy cable insertion
- Closed transition protects end of cable from environmental conditions
- **Four hole NEMA mounting pad assures maximum secureness and surface contact area**
- Long barrel provides high pull out force and added secureness for improved mechanical and electrical properties
- Color coded barrels are marked with die index numbers
- Connectors are suitable for voltages up to 35 KV
- 45° and 90° angles are UL listed
- **Connectors are UL listed with Penn-Union, Burndy, T&B, Huskie, Greenlee and Versa-Crimp® style tooling**

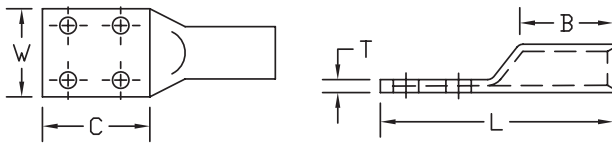

BBLU-FN DIMENSIONS & INSTALLATION TOOLING INFORMATION

CATALOG NUMBER	COPPER CONDUCTOR SIZE	STUD HOLE SIZE	FIGURE DIMENSIONS (IN.)						INSTALLATION TOOLING			WIRE STRIP LENGTH
			STUD HOLE SPACING	TONGUE WIDTH "W"	TONGUE LENGTH "C"	TONGUE THICKNESS "T"	BARREL LENGTH "B"	OVERALL LENGTH "L"	COLOR CODE	BURNDY DIE INDEX NO.	PENN-UNION DIE CATALOG NO.	
BBLU-100-FN	1000 kcmil	1/2"	1.75	2.88	3.00	.33	3.00	7.06	White	27	T-27P	3-1/8"
BBLU-125-FN	1250 kcmil	1/2"	1.75	3.00	3.00	.30	3.19	7.44	Yellow	29	-	3-5/16"
BBLU-150-FN	1500 kcmil	1/2"	1.75	3.00	3.00	.39	3.06	7.41	Green	31	T-31P	3-3/16"
BBLU-175-FN	1750 kcmil	1/2"	1.75	2.91	3.00	.39	3.09	7.88	Gray	33	-	3-3/16"
BBLU-200-FN	2000 kcmil	1/2"	1.75	3.08	3.00	.47	3.44	7.75	Brown	34	-	3-9/16"

• For 45° or 90° BENT TONGUES add suffix "-45" for 45 deg. or "-90" for 90 deg. to the catalog number